

ARCHITECTURE CORE STUDIO II
THE PROTO-CEMETERY
A MACHINE OF DEATH AND LIFE

FINAL REVIEW

DANESH AJITH

1005643



Speculative References: Technological Fiction
Ignatius, Sarah, Joy

<Speculative References - Technological Fiction>



<Cryopreservation & Space Burials>

<Speculative References - Technological Fiction>

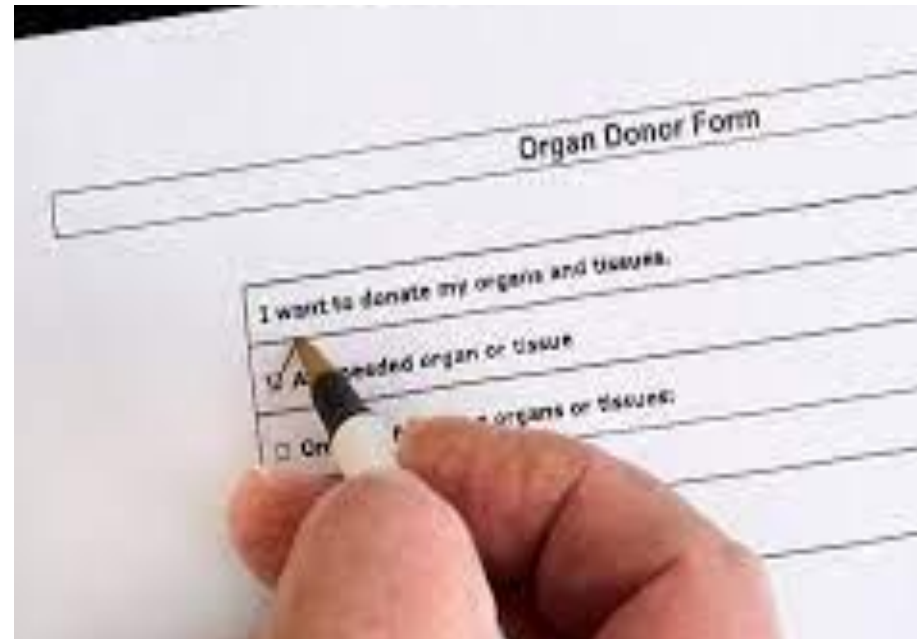

<Green burials & Organ Reclamation>

<Speculative References - Technological Fiction>



<Memory Archive & Preservation via other Media>

<Speculative References - Technological Fiction>



<Simulating loved ones & implantation of consciousness>



Speculative References: Environmental Future
Jeremy, Danesh, Hannah, Georgia

<Speculative References: Environmental Future>



- Climate change, temperature rise, lack of freshwater (drying of lakes, melting of glaciers, pollution of groundwater)
- Extreme weather
- Inundation of cities from rising sea level
- human accelerated natural disasters, earthquakes, volcanos, typhon, and tornado
- Cities abandoned, population displaced



<Future where current problems are not solved>

<Speculative References: Environmental Future>



- Social Issues Exacerbated
- Limited space dedicated for cemeteries
- Socio-economic divide for after death care
- Places to pay respect to the dead are more vertical due to space constraints



<Effect on society and death>

<Speculative References: Environmental Future>



- Clean energy
- Sustainable lifestyle
- Green and lush urban landscapes
- Technologically advanced
- One unified religion



<Future with green urban environment>

<Speculative References: Environmental Future>



- Cryonics
- Recompose
- Idealized way of laying the dead to rest, respects the dead and the environment



<Effects of encompassing a future with green urban environment>

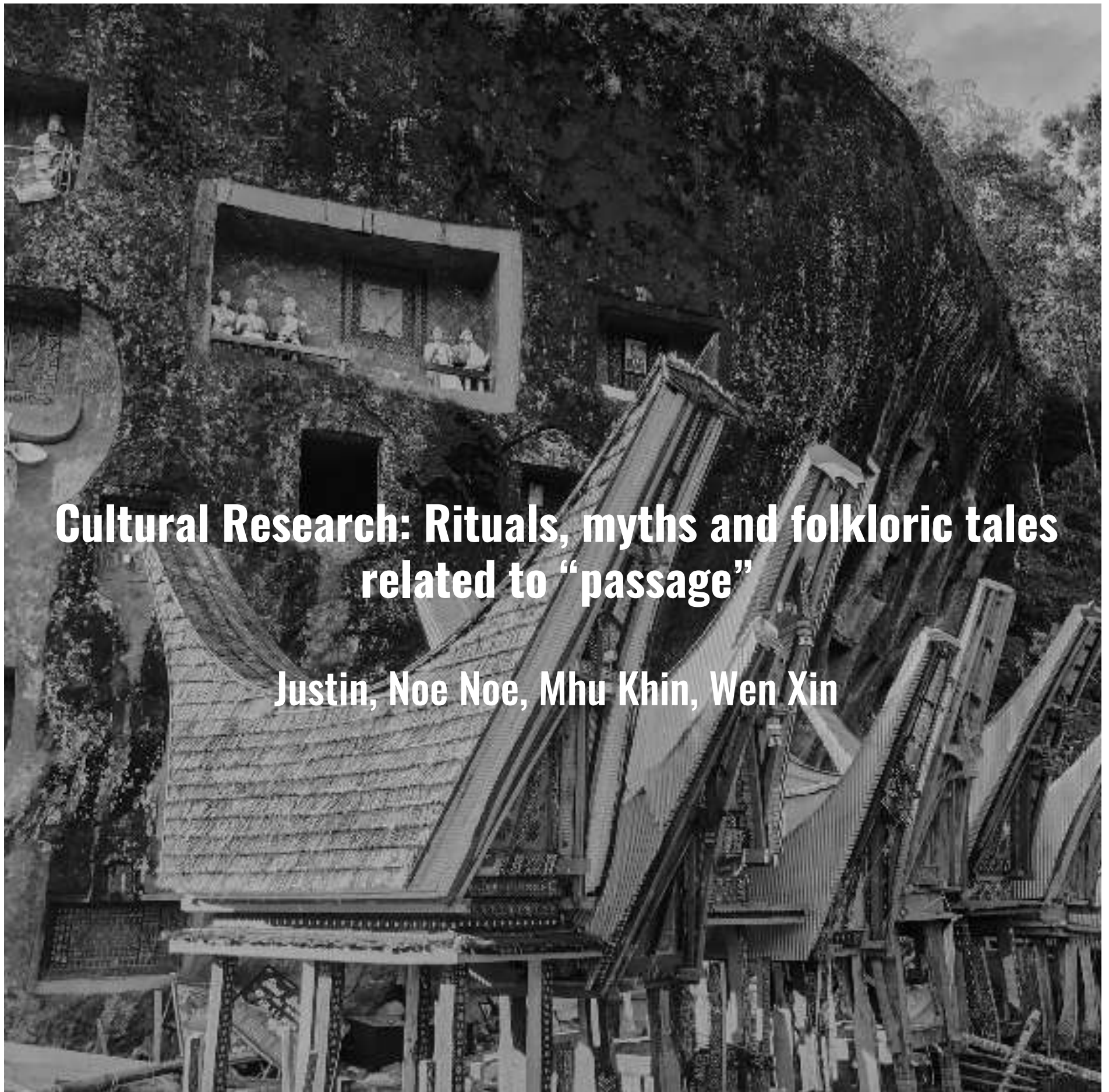

**Cultural Research: Rituals, myths and folkloric tales
related to “passage”**

Justin, Noe Noe, Mhu Khin, Wen Xin

<Cultural Research: Rituals, myths and folkloric tales>



Day of the dead

- Day when gates of heaven open allowing spirits of deceased to return to reunite with their families
- Mood of celebration, joy expressed through parade, singing and dancing
- Families prepare ofrendas with food their loved ones enjoyed



Aboriginal Mortuary Rituals

- Driving the spirit onward to its next life is crucial
- Smoking in his house
- Feast and celebrate with singing and dancing
- Taboo to speak the deceased's name

<Joyous - Intimate - Large/Small scale>

<Cultural Research: Rituals, myths and folkloric tales>



Toraja Ma'nene Ritual

- Every 1, 2 or 3 years, to honour the dead
- Bodies are dried, cleaned and redressed in new clothes and take pictures with the body
- Relatives parade the bodies around the village
- After their graves are cleaned, return to the original burial site



Hanging Coffins in Sagada

- Tied or nailed to sides of cliffs
- In a foetal position, wrapped in blankets and carried to the cliff site
- Mourners take turn to carry the corpse to be smeared with their blood and fluids
- Young men climb up cliff and place corpse inside hollowed out lumber coffin
- They are hung following the curvature of the cliff to enable the fluid runoff from the coffins to become natural fertilisers

<Grieving - Intimate - Large scale>

<Cultural Research: Rituals, myths and folkloric tales>



House of Bones (Australia)

- Houses 610 painted skulls (from a 12th century graveyard that was cleared)
- Due to a lack of graveyard space, the skulls are painted in the memory of the person
- As the collection of the skull grow, the church began to put the skulls on display, creating walkable rooms to emphasis the religious teaching, creating a *memento mori* (the remainder of inevitable death)

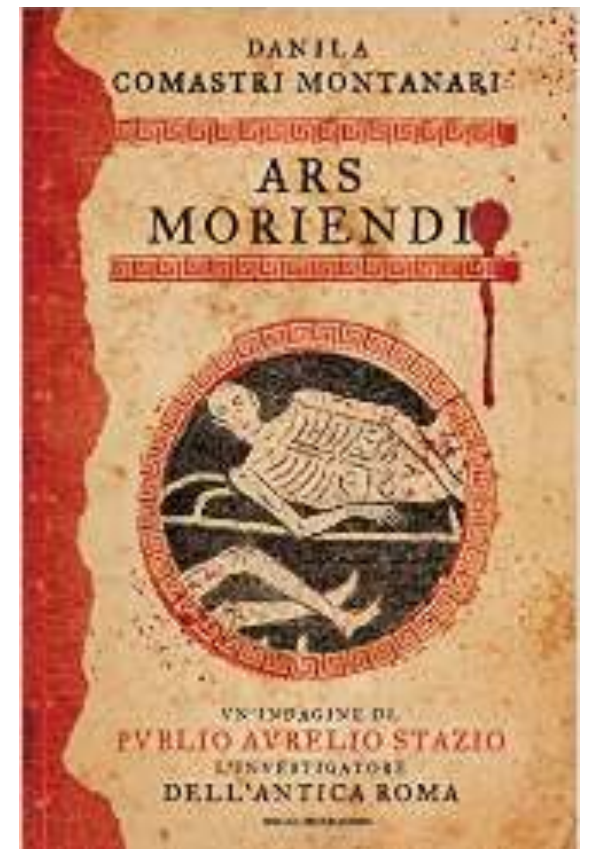

<Grieving - Mass gathering - Large scale>

<Cultural Research: Rituals, myths and folkloric tales>



Tibetan Buddhist Sky Burial

- Corpse is placed to be eaten by vultures
- Body is now an empty vessel
- Act of generosity
- Tibetan Buddhists encouraged to watch the ceremony



Korean Death Beads

- Deceased's ashes made into beads
- Gained popularity after the 2000s
- South Korean implemented a 60-year time limit for graves
- Lack of space
- Held in ornamental containers and plates

<Grieving - Intimate - Small scale>

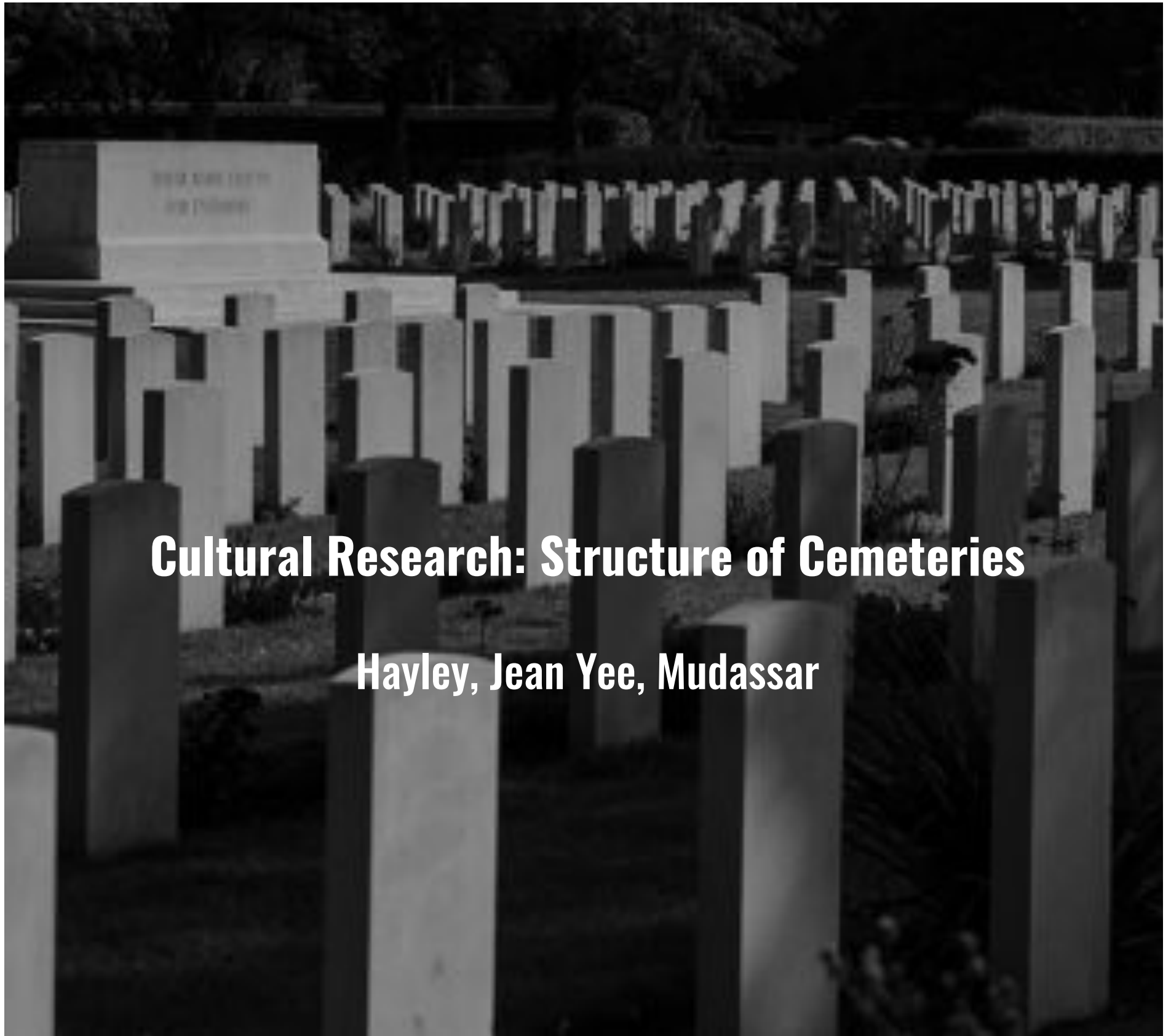

Cultural Research: Structure of Cemeteries

Hayley, Jean Yee, Mudassar

<Cultural Research: Structure of Cemeteries>



<Types of Cemeteries>

◁Cultural Research: Structure of Cemeteries▷

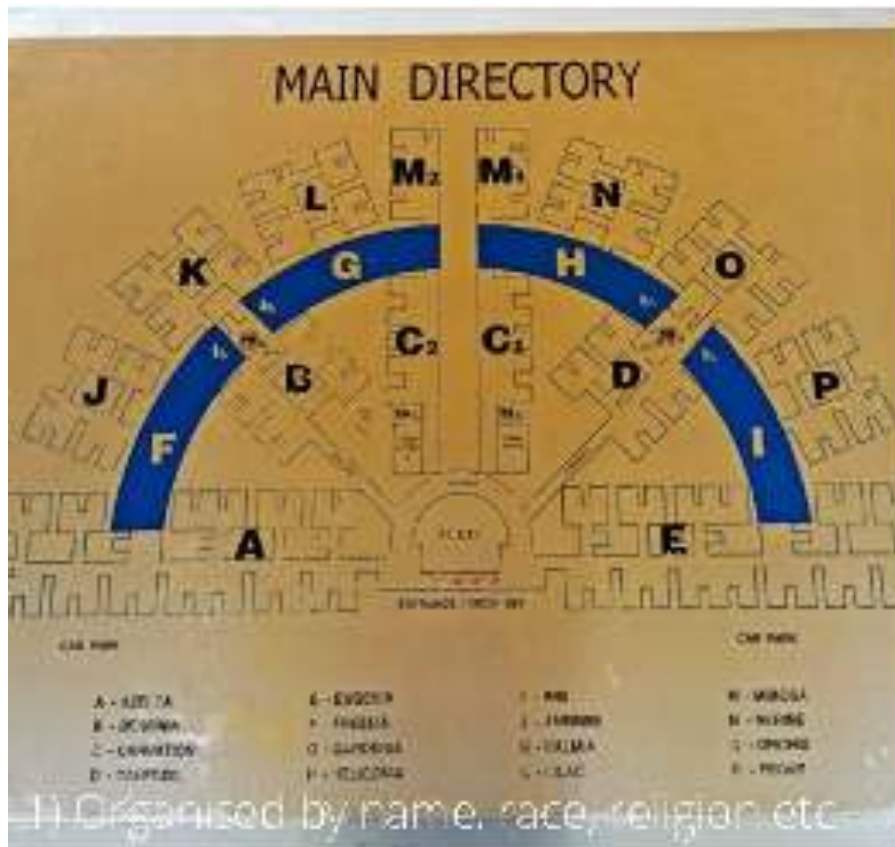

◁Structure of Cemeteries▷

<Cultural Research: Structure of Cemeteries>



<Contemporary Vertical Cemeteries>

<Cultural Research: Structure of Cemeteries>



<Cemetery Programmes>

After years of global warming and environmental disasters, cities have been inundated and civilization has been forced to seek higher ground for shelter and livelihood and to escape the now permanent pollution of the fully industrialized cityscape. What was once a dynamic urban landscape where one could work and play, has now been separated into different locations, only possible due to the ease of transport and low population, due to the several world wars.

Industrial zones have taken over what used to be cities, utilizing the now flooded streets for the production of goods and materials. The overtaking of cryptocurrencies and multibillion dollar companies monopolizing majority of the world's trades has led to a further dissolution of nations, along with cultures and traditions, with a diverse group of whoever remains banding together in a borderless society.

The lack of authority as well as the fight for better jobs has led to a vast income disparity between the common man and the rich. The lack of buildable space due to the flooding has led to cities being separated into several levels. While the rich experience fresh air, nature and clean cities in the sky, commoners are cramped into dense apartment complexes littered in between the urban jungle of factories and rivers, with the lucky few getting sunlight that seeps through the structure holding the city up.

The limited space has forced prices to skyrocket. While the rich enjoy farmed food and can afford the land to bury their dead, the common man gets their plant-based food from the cliff farms, which utilize the remains of those who can only afford human composting. While this concept may have seemed unreasonable back in the early 2000s, this has become a widespread cycle of life and death today. The trip to visit their loved ones who have passed also acts as a retreat to the common man, where they get to escape the ashy and dusty streets and the thick, polluted air, to experience the abundance of sunlight, the fresh mountain air and the quietness of nature.

Cliff farms have been separated into various zones; vertical farming for vegetables and a cliffside oasis for the growing of trees and crops. The heart of the machine contains the vessels where the bodies undergo the composting process to become fertilizer and spaces for loved ones of the deceased to mourn them. They may proceed on a walk of the grounds of the farm, and spend time amongst the lush life created with the help of their loved ones who have passed.

Thus a feedback loop is created, where the deceased pays the gift of sustenance forward, as they had received, allowing the creation of life from death.

the fully industrialized cityscape.

cities have been inundated

pollution of

*Industrial zones
of goods and materials.*

utilizing the now flooded streets

production

common man and the rich

a vast income disparity between the

HUNDREDS DEAD
IN QUAKE



Arctic Ocean Getting
Warm; Seals Vanish
and Icebergs Melt

Major Earthquake
Hurt in 6.6 Quake
Shock, Buildings Topple

The Oregonian

Eruption decapitates St. Helens
at least 9 die; Spirit Lake g



DEPORTATIONS TO BE

President Trump calls for increase of ICE force; cases continue

LISTEN:
PRESIDENT
ADDRESSES
THE NATION

the common man

human composting

cliff farms,

utilize

*the growing of trees and crops
the composting process*

heart of the machine

spaces for loved ones

vertical farming for vegetables

vessels

spend time amongst the lush

cliffside oasis for

undergo

to mourn

their loved ones who have passed.



Thus a feedback loop is created, where the deceased pays the gift of sustenance forward, as they had received, allowing the creation of life from death.

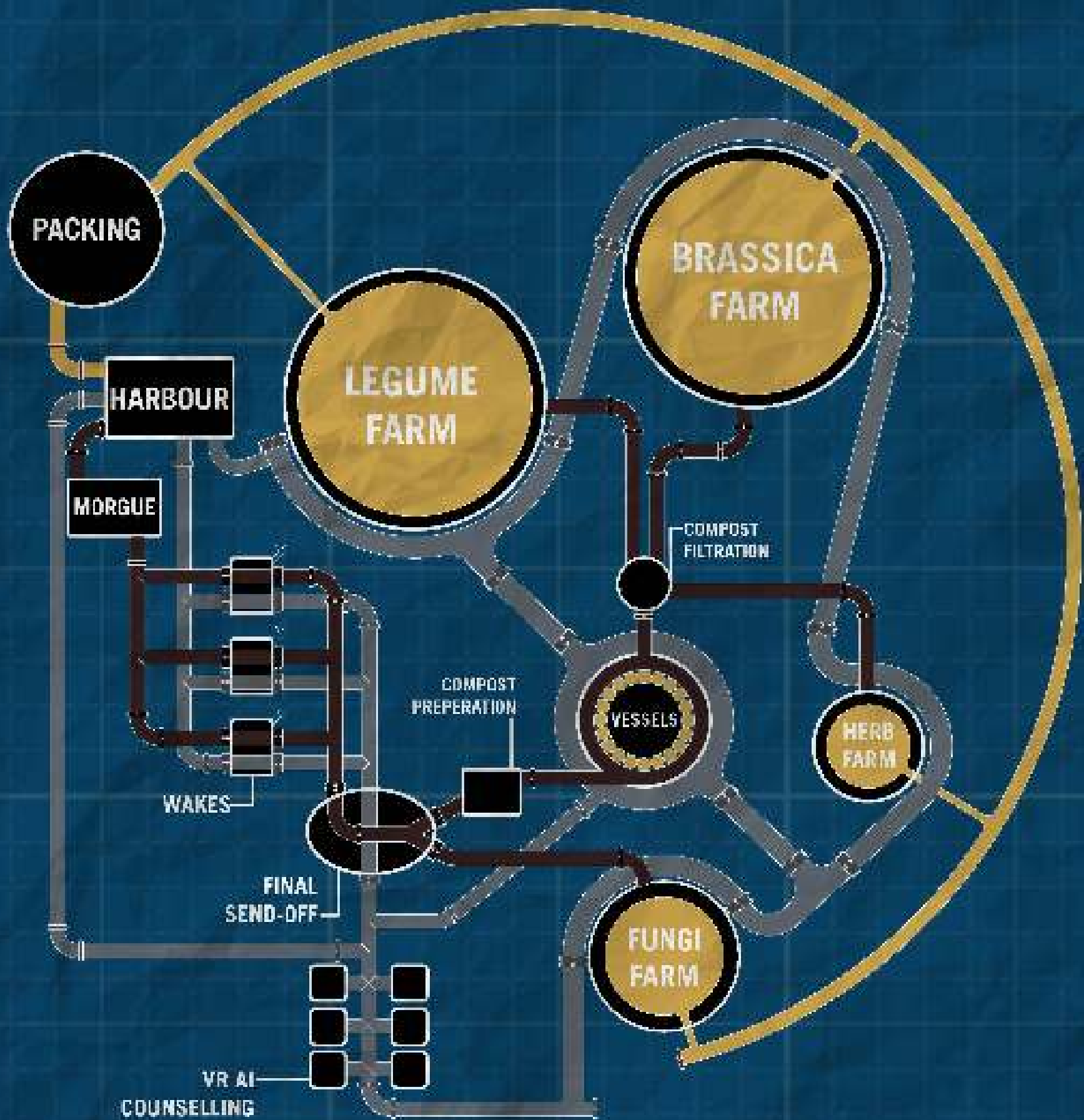

THE ANATOMY OF THE MACHINE.





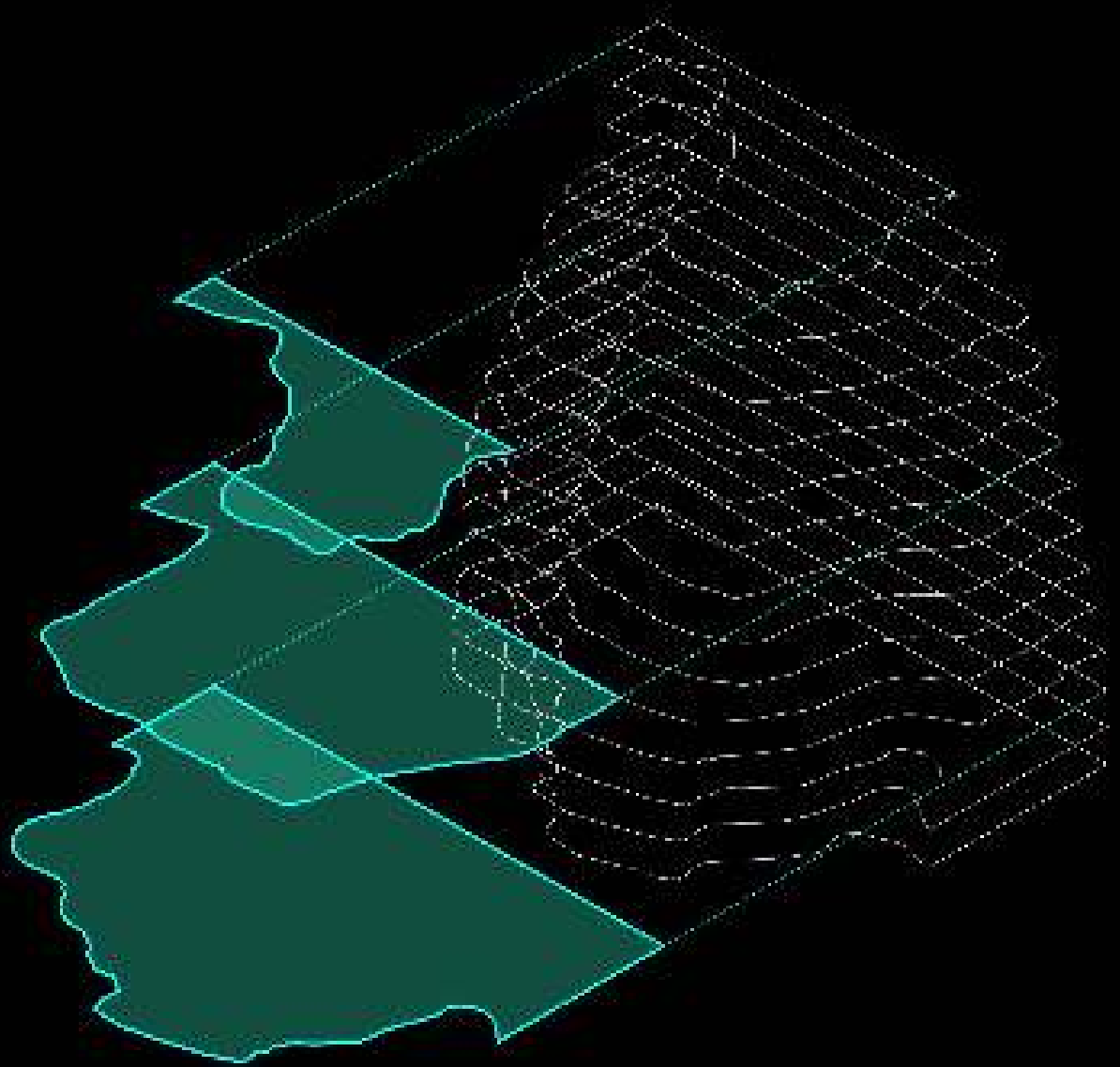
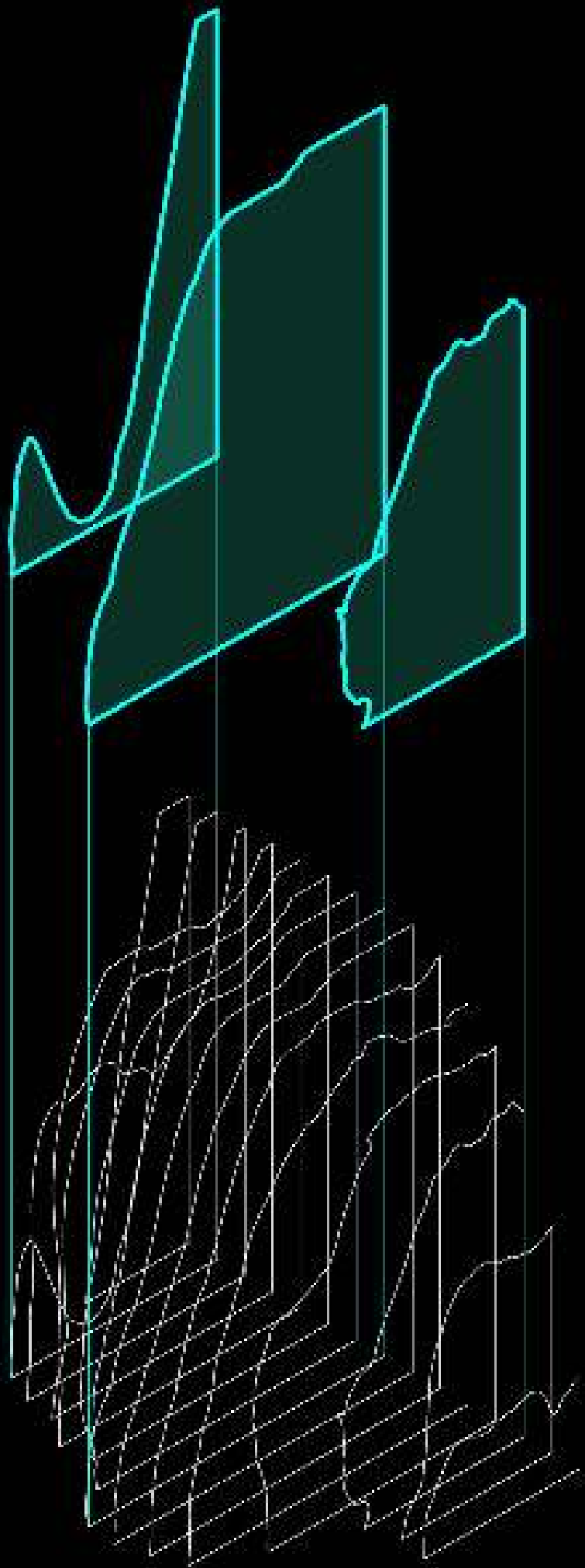

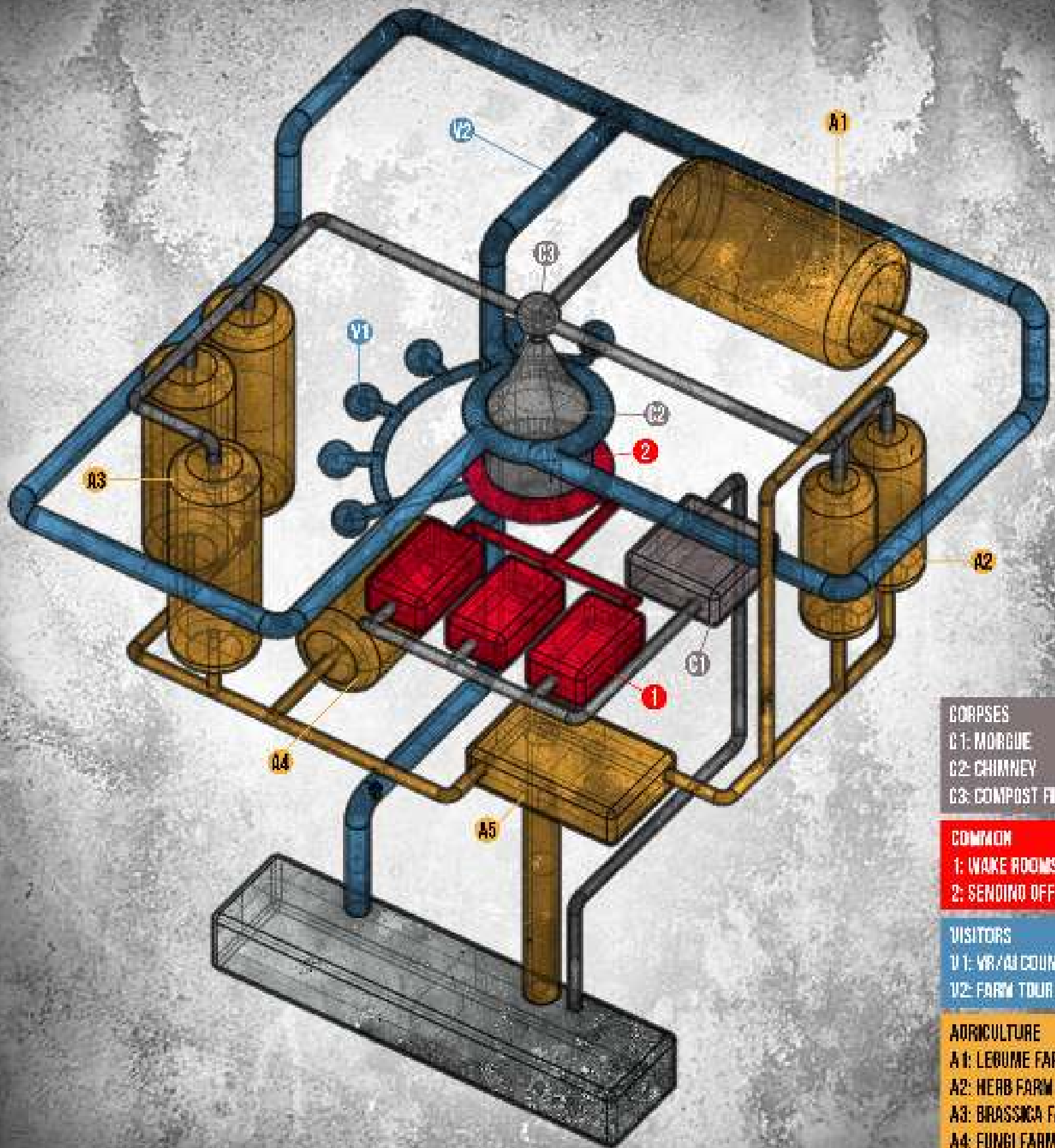

CORPSES
 C1: MORGUE
 C2: CHIMNEY
 C3: COMPOST FILTRATION

COMMON
 1: WAKE ROOMS
 2: SENDING OFF CEREMONY

VISITORS
 V1: VR/AI COUNSELLING PODS
 V2: FARM TOUR ROUTE

AGRICULTURE
 A1: LEGUME FARM
 A2: HERB FARM
 A3: BRASSICA FARM
 A4: FUNGI FARM
 A5: PACKING AND EXPORT

THE SKELETON OF THE MACHINE.

DEATH

- 1) Place of grief
- 2) Time of ritual
- 3) Place of transition
- 4) Place of remembrance

DEATH

Enter →

Place of Grief

Place of Ritual

Place of Transition

Place of remembrance

Skin & bone transferring

Composting vessel

Agreement

- LIFE**
- 1) Time date transitioning
 - 2) Vessel for composting
 - 3) Transfer of soil from to compost transfer
 - 4) Place of agreement

Transitioning
Time and material items
→ Time and location for space layout

Place
- low interconnectable
columns

LIFE

VERTICAL

- BRASSICAS
- Herbs
- Legumes
- Fungi

- crops grow on membranes, space
- water harvesting & recycling

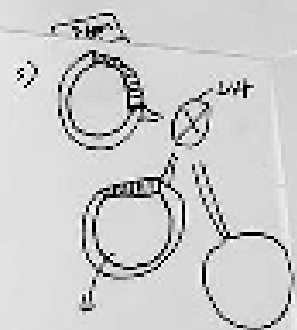

HORIZONTAL

- CORN
- WHEAT

- Kobs more space required
- lettuce more compact

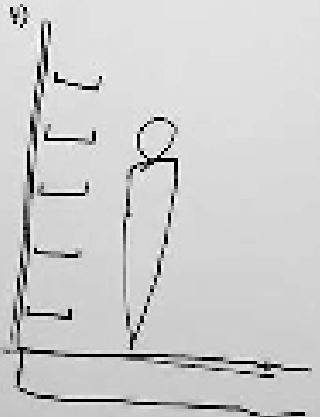
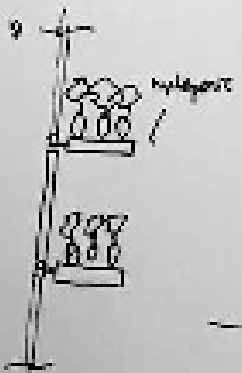
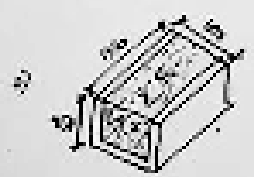
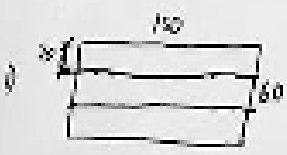

- support for corn/wheat fields

More Fungi
More than 1 stage long → Shrooms

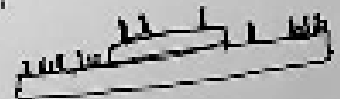
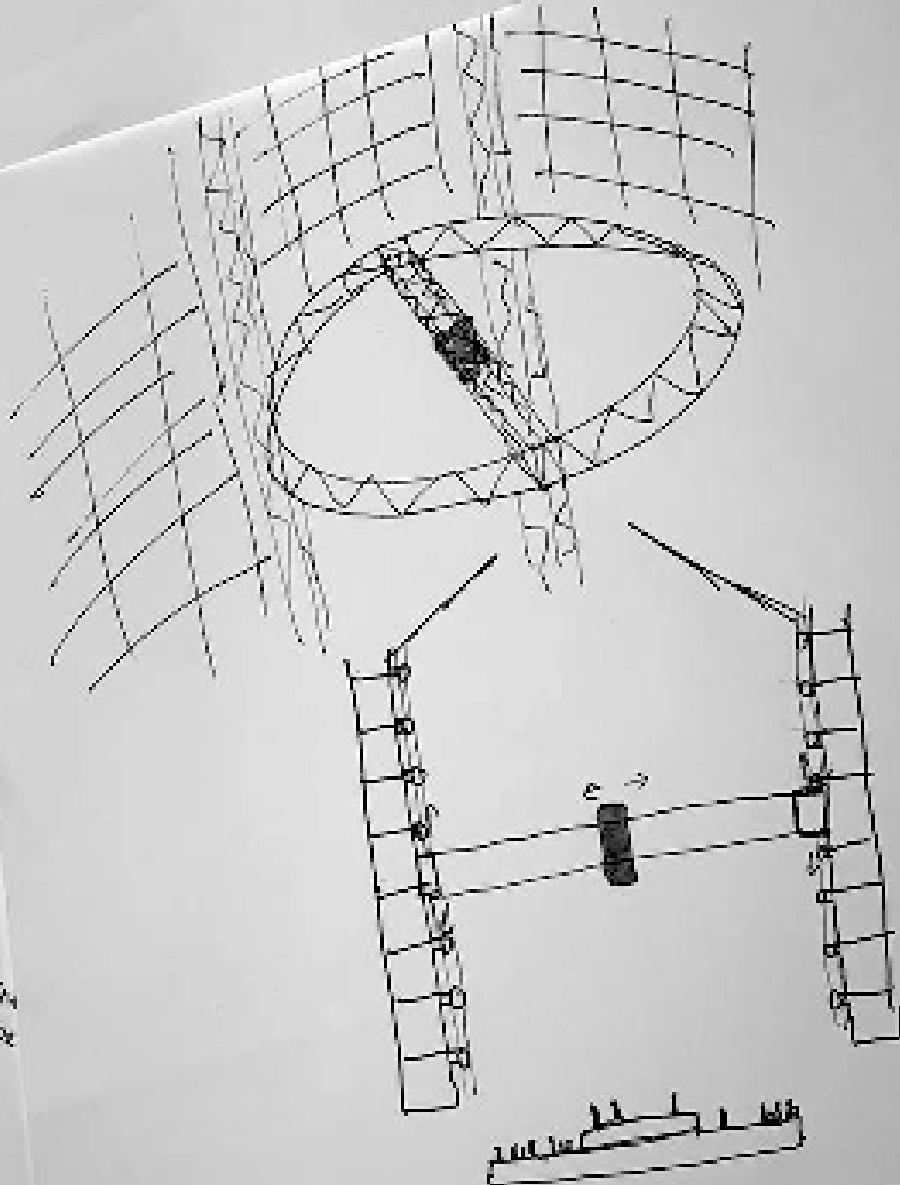









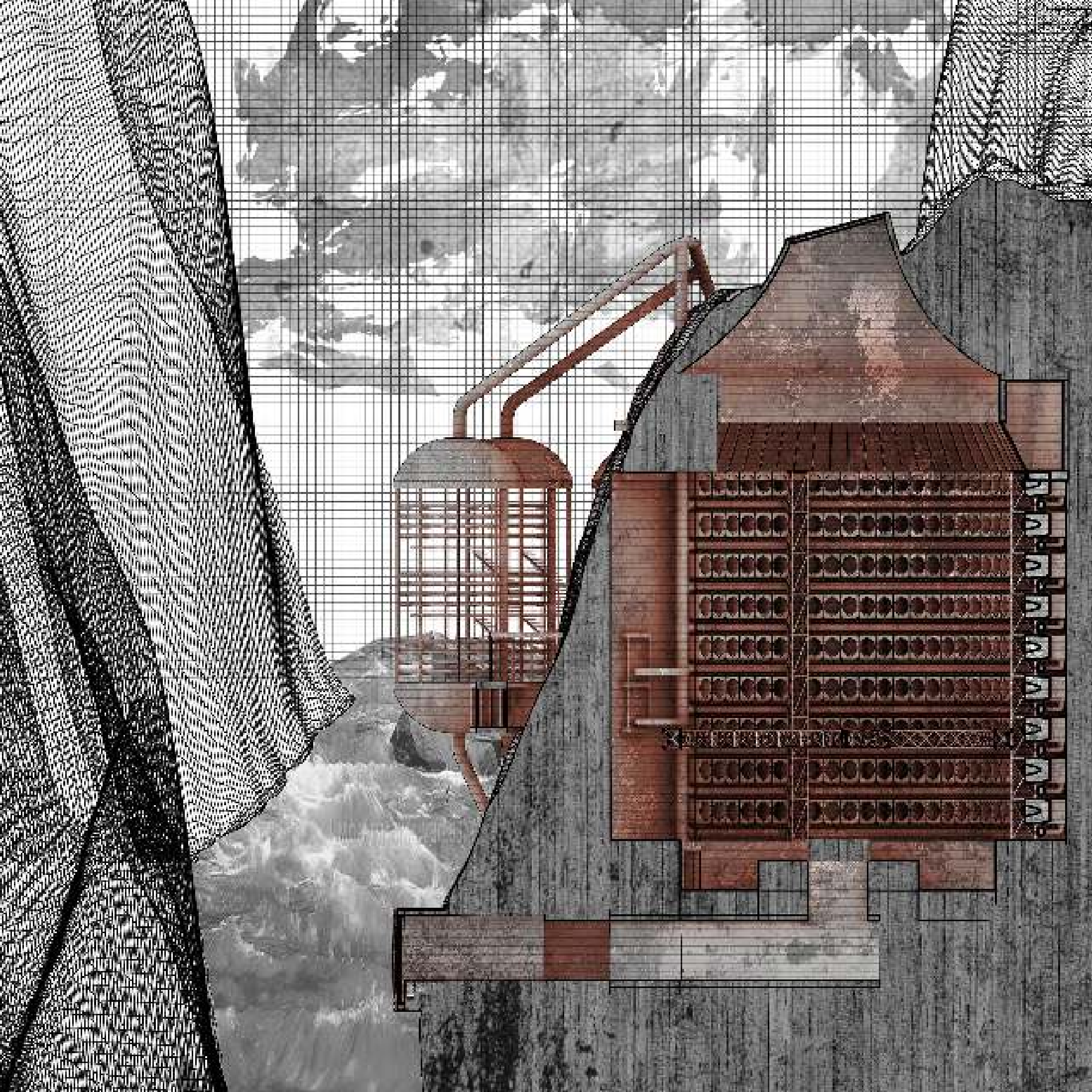

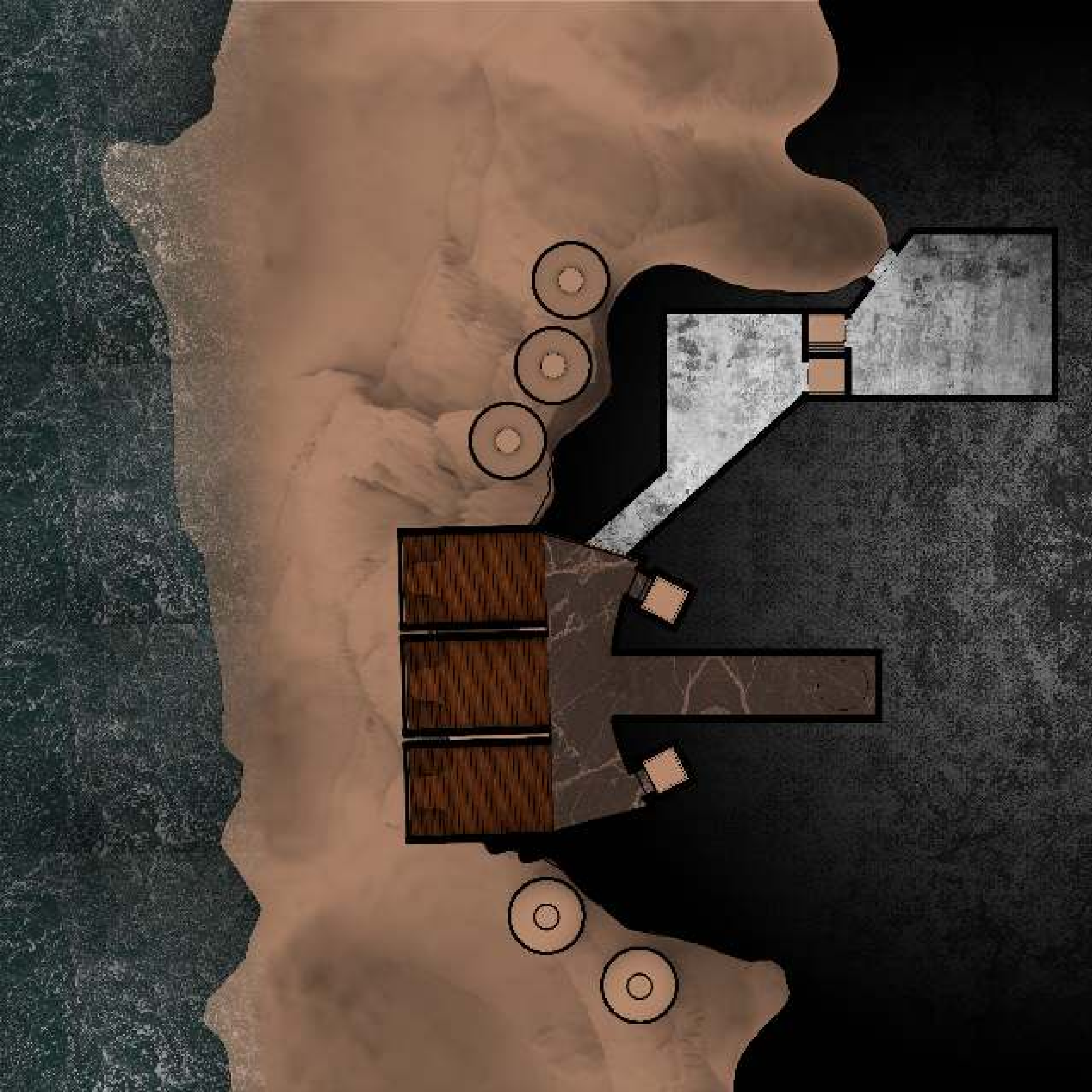



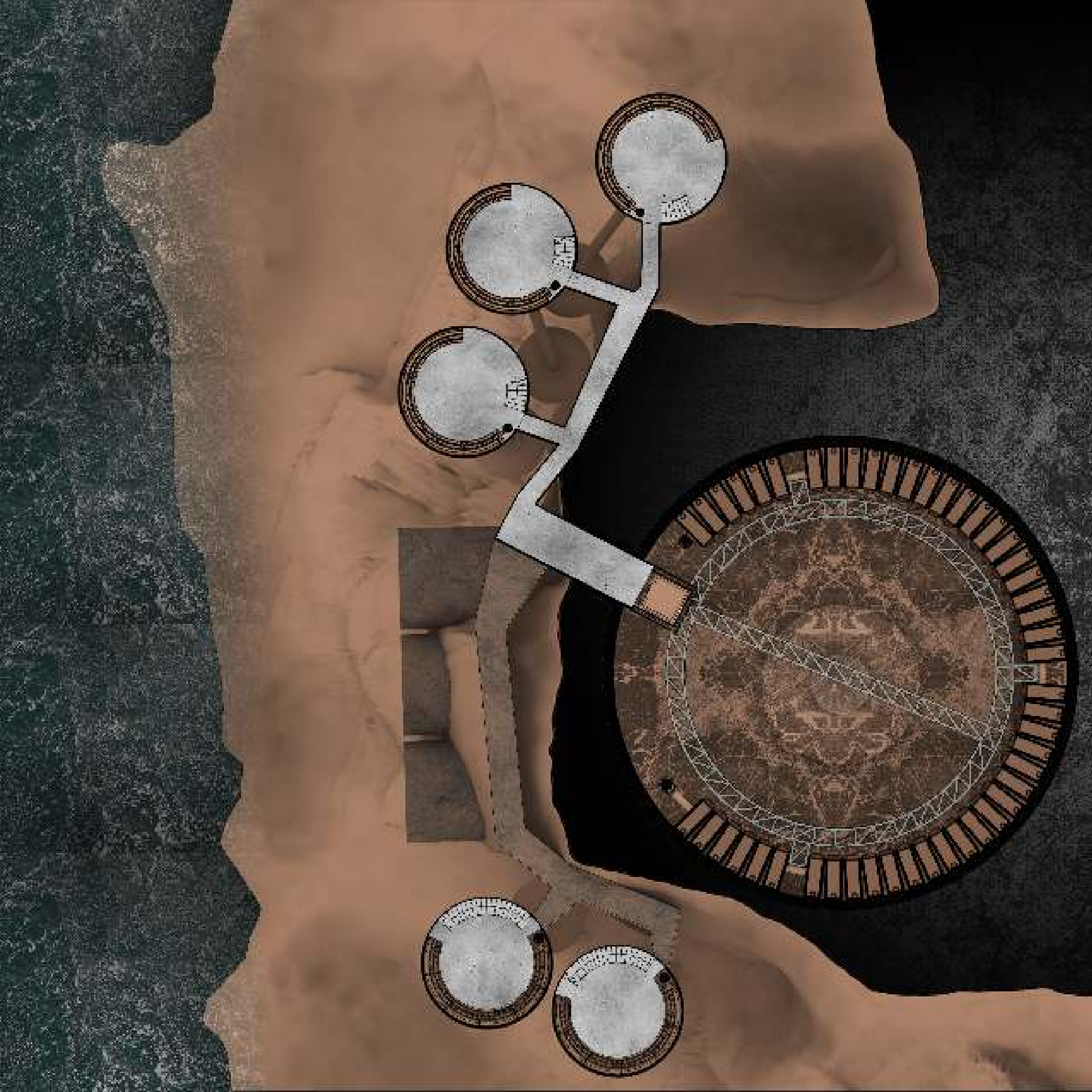



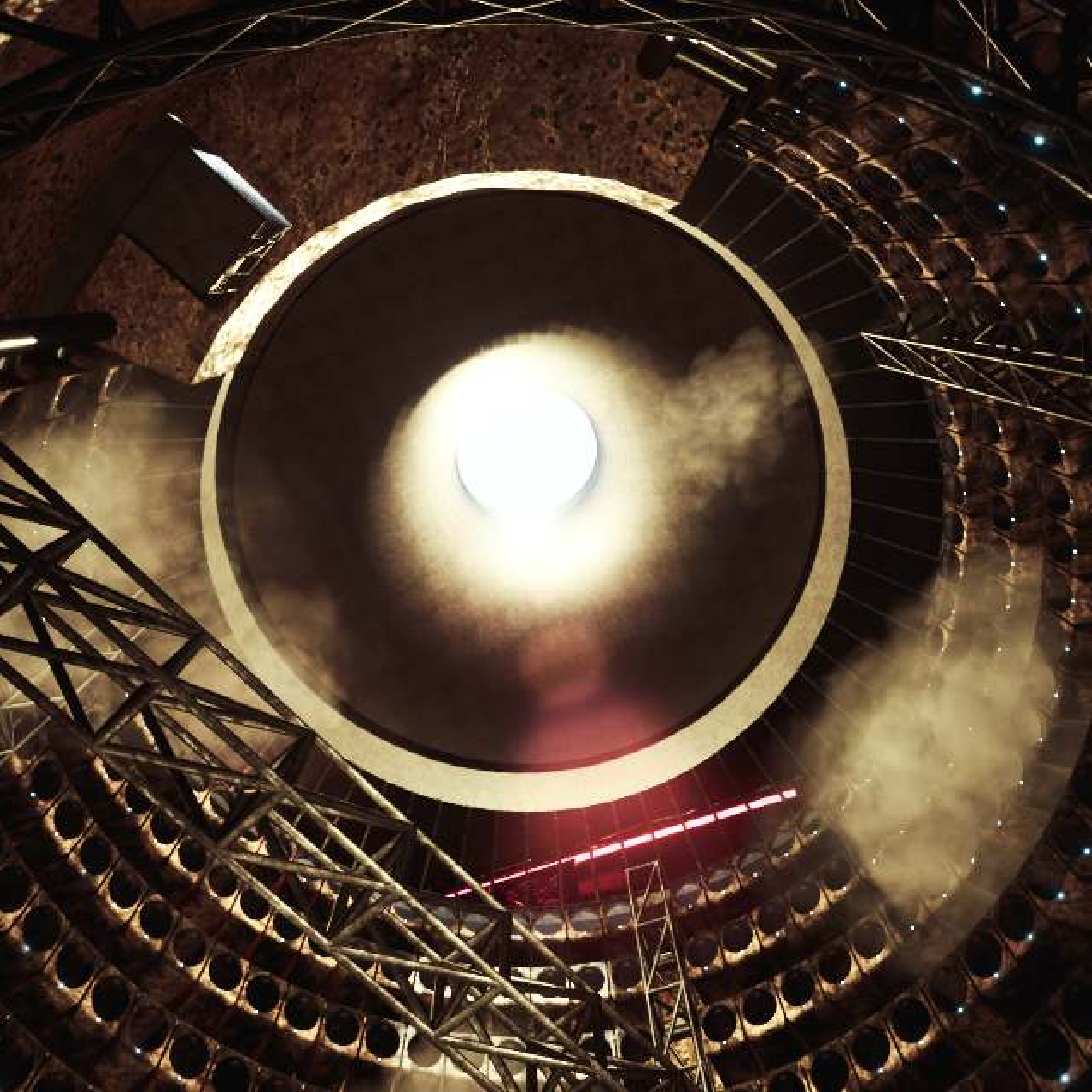

READY

VERTICAL HERB TRAY 2
MAX SPAN HEIGHT: 10 FT 0 IN
MAX UNIFORM L.O.D.: 100 LBS
MAX TOTAL UNIFORM L.O.D.: 100 LBS
MAX POINT LOAD: 100 LBS







Assembling the Machine

NOTE:

Cliffsides with a heavy flow of water are preferred to reduce the chances of piping failure. Cliff should initially be carved out to provide sufficient space for the composting atrium and control rooms. Dimensions provided on blueprints.

Step 1:
Make room modules x 3 to be slot into lowering forming outward.

Step 2:
Input room x 1, Output room x 1, must be combined and slanted, gently be slot into lowering from the slant side.

Step 3:
Pig Herb farms x 2, Brassica farms x 3 into walkway.

Step 4:
Walkway can be inserted into void produced in slant section. This location will be used to the main elevator.

Step 5:
Pig Herb farms x 2, Brassica farms x 3 into walkway.

Step 6:
Compost export pipes x 5 to be piped with main vessel module pipes.

Step 7:
Place Control room x 1 on top of main vessel module.

Step 8:
Insert Daylight cone x 1 to complete.

